

ATARI® Mouse

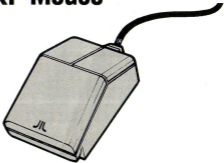

For all MEGA™, ST™
and Atari PC computers.

Atari Mouse

The Atari mouse is a small, hand-manipulated device that you connect to your Atari computer. Once it's connected, the mouse controls the movements of the cursor on the monitor screen. When you move the mouse over a flat, horizontal surface such as a tabletop, the cursor on screen moves in the same direction.

To connect the mouse to your computer, insert the plug at the end of the mouse cable into the mouse port on the Atari computer. (See your Atari computer manual for the specific location of the port.) The plug is larger at the top and will fit into the port in only one way. The mouse can remain permanently connected to your computer, or you can unplug it to use its port as a joystick connection.

Mouse Care

Your Atari mouse is designed to last through years of use as long as it's handled properly. Follow these guidelines for mouse care:

- Don't drop the mouse.
- Don't let the mouse hang by its "tail."
- Keep the surface on which you move the mouse smooth and clean.

Cleaning the Mouse

You'll need to clean the mouse periodically to ensure its proper operation. Follow the steps below:

1. Turn the mouse upside down in your hand with its "tail" pointing towards you.

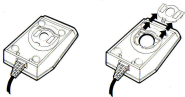

2. Place two fingers on the arrows on either side of the roller opening on the bottom of the mouse. Push down and away from you until the roller panel pops loose. Remove the panel.
3. Holding one hand over the mouse, turn the mouse over so the roller drops into your hand.

4. Use a soft, clean, dry cloth to wipe the roller clean. DO NOT USE a cleaning fluid or lint-creating tissue.
5. Gently blow into the roller housing to get rid of dust.
6. Replace the roller in its housing. Reinsert the roller panel, then push it down and backwards until it locks in place.



ATARI, the ATARI logo, MEGA, and ST are trademarks or registered trademarks of Atari Corporation.

Copyright ©1988, Atari Corporation, Sunnyvale, CA 94086. All rights reserved.

Printed in Taiwan.

K. L. I. 1988

C100971-001